

SECTION 1: REQUEST FOR QUOTATION (RFQ)

Center for Environment Education (CEE) kindly requests your quotation for the scope of work as detailed in Annex 1 of this RFQ. This Request for Quotation comprises the following documents:

Section 1: This request letter

Section 2: RFQ Instructions and Data

Annex 1: Schedule of Requirements

Annex 2: Quotation Submission Form

Annex 3: Technical and Financial Offer

Annex 4: Forms for release of payments

When preparing your quotation, please be guided by the RFQ Instructions and Data. Please note that quotations must be submitted using Annex 2: Quotation Submission Form and Annex 3 Technical and Financial Offer, by the method and by the date and time indicated in Section 2. It is your responsibility to ensure that your quotation is submitted on or before the deadline. Quotations received after the submission deadline, for whatever reason, will not be considered for evaluation.

The Request for Quotation process shall be as follows:

The interested bidders may proceed to submit their supporting documents and rates by sending an Email to purchase@ceeindia.org.

The email must contain the following:

- The bid should be signed and duly stamped on letter head.
- Bidder should mention GST No. in the bid and share GST No. copy.
- All the applicable taxes should be mentioned in bid.

You are requested to submit your bid with all necessary documents on 06-06-2023 till 05:00 PM.

Thank you and we look forward to receiving your quotations. Issued by:

Yogesh Kumar

9899988486

Introduction:

Swachh Centre's (MRC's) Centres are defined as "integrated material recycling centres" for recycling all types of plastic waste; which is collected with support from City Municipal Corporations (CMCs) or equivalent and by the Waste Pickers (Safai Mitra's), Service Providers (SPs), in every city. The centres enable segregation of all types of plastics, adds product value, for increased incomes of Safai Mitra's. Links the waste collectors with recyclers along the value chain particularly for the low-grade, thin plastic litter bags, multi-layered plastics, PET, rigid plastics of all types in the city.

The Swachh Centres (MRCs) are largely, integrated within the existing systems and can cater 05 MTs of plastic waste per day. This can be done using different mechanical operations, Grinding Machine, Washing Line, Effluent Treatment Plant, Dryer, Agglomeration Machine, Mixer and Mother Baby Extruder.

A. Scope of work:

CEE in partners with City Municipal Corporation's (CMC) & HDFC Bank are establishing a Swachh Centre's (MRC's) at the **Different Cities of India** and Installing machines to promote segregation and processing of plastic waste.

There is a requirement of **Civil Work for Underground Water Tanks with Platform of 5 Ton Loading Capacity and Supply, Installation, Training and Commissioning of Effluent Treatment Plant at Jammu Material Recycling Centre, Bandurakh, Kunjawani, Jammu** to be use for processing plastic waste. The BOQ of Civil Work and specifications of Effluent Treatment Plant are attached herewith in **Annexure 2**.

Note: Supply of machine includes cost of packing, loading, unloading, transit Insurance and Transportation of machine.

A. Bidder's Qualification:

- Bidder should have at least **03 years'** experience in manufacturing and supplying of Effluent treatment Plant and Civil Work for erection of underground tanks with platform of **05 ton loading capacity**.
- Bidder should submit related works orders / completion certificates from minimum **03 parties in last two financial years**.
- Bidder should have done minimum of **Rs. 35 Lacs at an average in the last 02 financial years**.

B. Documents to be submitted:

Bidders shall include the following documents in their quotation:

- Technical and Financial bid (separately) duly completed and signed and in accordance with the Schedule of Requirements in Annex 1.
- Company Profile.
- Registration certificate;
- Descriptive Literature: Bidders shall provide full technical details of products being offered, including technical sheets and pictures showing details and general views. Specific details of items offered should be clearly stated as standard catalogues may offer options;
- Documents showing that the bidder has supplied similar machineries to private/ public sector/ government organizations – **proof of two purchase orders/ contract**.
- Documents showing that the bidder has an experience of a **minimum of three (03) years of supplying of similar machineries**.
- Statement of satisfactory Performance (Certificates) from the top two clients in terms of Contract value in similar field, plus client's contact details who may be contacted for further information on those contracts;
- You are requested to submit the quotation through mail as per the guidelines provided below.
- The bid should be submitted on Company Letter Head.
- The Company GST number to be mentioned.
- The bid should be signed and duly stamped.
- Bidder should submit related works orders / completion certificates from minimum 03 parties in last two financial years.
- All bids should be sent in the name of Center for Environment Education, purchase@ceeindia.com
- All the applicable taxes should be clearly mentioned in bid.
- The bidder should submit bid in accordance of the following:
 - File Format: PDF files only
 - All files must be free of viruses and not corrupted.
 - The interested bidders may proceed to request for the RFQ document by sending an Email to **purchase@ceeindia.org** or by submitting sealed envelope to **Centre for Environment Education, Thaltej Tekkra, Ahmedabad – 380054**. In the

email or Sealed Envelope

- C. Duration:** The duration of said work in Annexure 2 shall be within a maximum period of 60 days from the date of receipt of Work Order.

D. Payment terms & Conditions:

a) Civil Work of Underground Tanks with 5 Ton Loading Capacity Platform:

The payment schedule is as follows:

- CEE shall, upon a written request from vendor, allow maximum **40 %** of the total value of job order and submission of work plan of 50 days and after signing the job order.
- CEE shall, upon written request from vendor, completion of reinforcement of underground water tanks, allow **40%** of total civil work of underground water tanks work amount as the second installment after verification of the work by CEE representative.
- The Vendor may submit a request of the final payment of **20%** installment to be paid by the CEE on completion of the 5 ton loading capacity platform with underground water tanks and commissioning & training of CEE & Recycling Partner team at the Jammu MRC.
- The final payment will be made once after verification and certification of work done by CEE representative.

b) Supply, Installation, Training and commissioning of Effluent Treatment Plant (25 KLD):

- CEE shall, upon a written request from vendor, allow maximum **40 %** of payment after signing the purchase order.
- Start of fabrication of machines, CEE representative will do pre-inspection of machines and plant.
- CEE shall, upon a written request from vendor after successful delivery of machine at MRC Centre, allow **40%** as second installment of the total contract amount after completion of fabrication and the post-inspection after machines ready for dispatch to be done by CEE representative.
- The Vendor may submit a request of the **15%** payment to be paid by the CEE on completion of the Installation, commissioning, and training of the Effluent Treatment Plant at the Jammu MRC. The payment will be made after verification and certification of successful installation, training & commissioning by CEE representative.
- The final payment of **5% will be made after 06 month** satisfactory operation and service of ETP plant upon verification and certification by CEE representative.

E) Liquidated Damages:

Failure to comply with the Terms & Conditions of the contract will result in the payment of corresponding penalties /liquidate damages in the amount equal to 100 % of the cost of the unperformed portion for every day of delay.

F) Penalty Clause:

Failure to complete the said works within given timeframe will result in the **penalty of Rs. 3,000/- per week** for the extended period of work.

ANNEX 1: SCHEDULE OF REQUIREMENTS
Technical Specifications
LOT 1: UNDERGROUND TANKS CIVIL WORK

ESTIMATE OF THE UNDERGROUND TANKS CIVIL WORK									
S. No.	PARTICULAR	Measurement				QTY	UNIT	RATE	AMOUNT
		NO	L	B	D/H				
CIVIL									
1	Earth work in excavation by manual means in trenches for foundations, drains, pipes, cables etc. (Not exceeding 1.5 meter in width) and for shafts, wells, cesspits and the like not exceeding 10 sq. meter on plan, depth up to 1.5meter. including disposal of excavated earth up to 1 meter from cutting edge, disposed earth is to be levelled and neatly dressed in:								
	All Kinds of soil								
	FOR TANKS	1	10.10	4.00	3.00	121.20			
	EXTRA EXCAVATION ON SIDES FOR SLAB	2	10.10	1.00	0.30	6.06			
					Total		127.26	cum	
2	Filling available excavated or earth (excluding rock) in trenches, plinth, sides of foundations etc. in layers not exceeding 20cm in depth, consolidating each deposited layer by ramming and watering, lead up to 50 m and lift up to 1.5 m								
	RAMMED EARTH AROUND TANK WALLS & FLOORS					84.84			
						84.84	cum		
3	Supplying, filling, spreading & levelling gravels of size range 5 mm to 10 mm, under plinth level over the existing layer of compacted earth, in required thickness, for all leads & lifts, all complete as per direction of Engineer-in- charge								
	1' DEPTH BELOW TANK FLOOR	1	10.10	2.50	0.30	7.58			
						7.58	cum		
4	1:2:4 (1 cement: 2 coarse sand: 4 graded stone aggregate 20mm nominal size).								
	12 INCH THICK WALLS FOR TANKS PERIPHERY	1	0.30	3.00	24.00	21.60			
	12 INCH THICK FLOOR FOR TANKS	1	0.30	10.10	2.50	7.58			
	8 INCH THICK TOP FOR TANKS CONTINUOUS SLAB SPANNING BOTH TANKS	1	0.20	10.20	4.40	8.98			
	3INCH PCC BOTTOM BASE FOR TANKS	1	0.08	10.10	3.20	2.42			

	3INCH PCC BOTTOM BASE 8" BELOW GROUND LEVEL	2	0.08	10.10	1.00	1.62			
	RCC PARTITION TYPE 1	5	0.30	2.00	2.50	7.50			
				Total		42.19	cum		
5	Up to 2 Floor, Providing and placing in position reinforcement for R.C.C. work including straightening, cutting, bending, binding etc. complete as per drawings including cost of binding wire in foundation and plinth all complete:								
	TANK TOP SLAB REINFORCEMENT LONGER SIDE 12MM 6" C TO C REINFORCEMENT CONSIDERED FOR CONTINUOUS SLAB SPANNING BOTH TANKS AND THE GAP	1.00	32.00	10.10	0.90	291			
	TANK TOP SLAB REINFORCEMENT SHORTER SIDE 10MM 8" Centre TO Centre REINFORCEMENT CONSIDERED FOR CONTINUOUS SLAB SPANNING BOTH TANKS AND THE GAP	1.00	50.00	4.40	0.70	154			
						444.88			
	TANK BOTTOM SLAB REINFORCEMENT LONGER SIDE 10MM 6" Centre TO Centre	1	32.00	10.10	0.70	226.24			
	TANK BOTTOM SLAB REINFORCEMENT SHORTER SIDE 10MM 6" Centre TO Centre	1	50.00	2.50	0.70	87.50			
	TANK WALLS REINFORCEMENT PERIPHERY 10 MM 6" CENTER TO CENTER					313.74			
		1	17.00	24.00	0.70	285.60			
	TANK WALLS REINFORCEMENT PARTITION 10MM 6" Centre TO Centre	5	17.00	2.00	0.70	119.00			
						404.60			
	Total weight					1163.22	Kg		
6	Providing and fixing form work including centring, shuttering, strutting, staging, propping bracing etc. complete and including its removal at all levels, for: Foundations, footings, bases of columns etc. for mass concrete.								
	TOP SLAB	1	35.00	14.00		490.00			
	BOTTOM SLAB	1	35.00	9.00		315.00			
	WALLS PERIPHERY	1	75.00	9.00		675.00			
	WALLS PARTITION	5	7.00	9.00		315.00			
						1795.00	Sq. ft.		

7	Providing M.S. foot rests including fixing in manholes with 20x20x10 cm cement concrete blocks 1:3:6 (1 cement : 3 coarse sand : 6 graded stone aggregate 20 mm nominal size) as per standard design :								
	ACCESS STEPS FOR BOTH TANKS: With 20x20 mm square bar	2			5.00	10.00	EACH		
8	Heavy duty cast iron manhole cover, 560 mm dia., min capacity 2ton	2				2.00	EACH		
							Sub Total		

ETP COLLECTION TANK CIVIL LAYOUT - PLASTIC RECYCLING

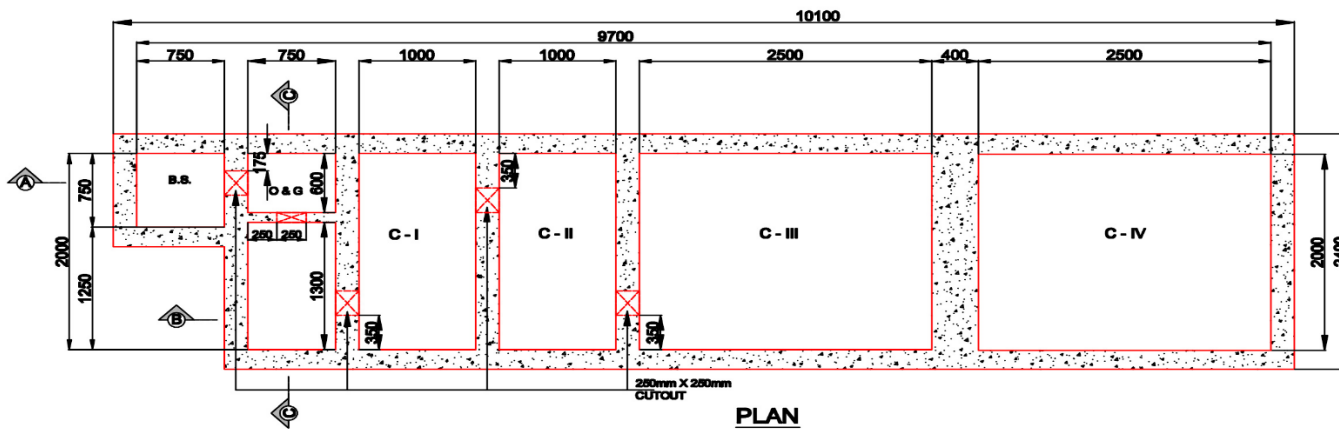
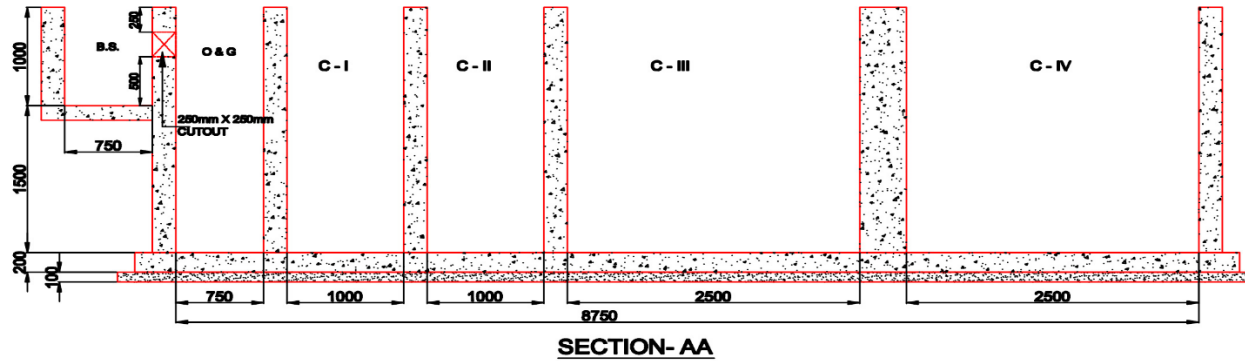
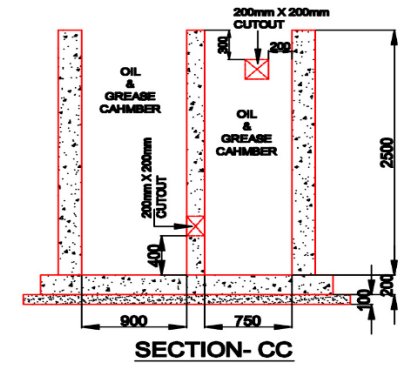
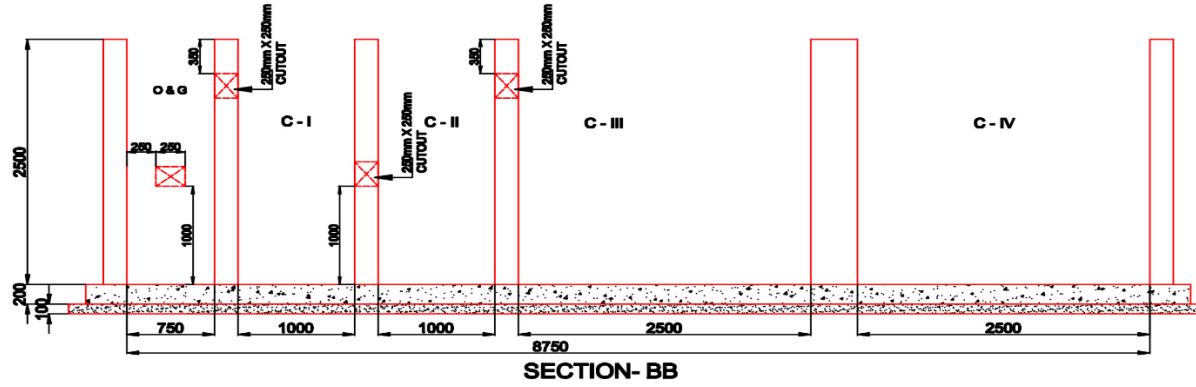

LEGEND		
TAG NAME	NAME	DIMENSION (In mtr.)
B.S.	Bar Screen Chamber	0.75 X 0.75 X 1.0
O & G	Oil & Grease Chamber	0.75 X 2.0 X 2.50
C I	Collection tank- I	1.0 X 2.0 X 2.5
C II	Collection tank- II	1.0 X 2.0 X 2.5
C III	Collection tank- III	2.5 X 2.0 X 2.5
C IV	Collection tank- IV	2.5 X 2.0 X 2.5
PROJECT:- ETP COLLECTION TANK		
CONSULTANT:-		
DRAWING TITLE:- BAFFLED COLL. TANK		
DRAWING No.:- CIVIL LAYOUT		
DRAWN BY:-	G.A.	REV. DATE
CHECKED BY:-	V.K.	
APPROVED BY:-	D.S.	
DATE:-	2023	
REVISION No.:-	00	

LOT 2: EFFLUENT TREATMENT PLANT:

Bill of Quantity for Effluent Treatment Plant JAMMU					
S. No.	Particulars	Qty.	Unit	PRICE	AMOUNT
1.0	EFFLUENT TREATMENT PLANT (25 KLD) Broad Details				
	Supply, erection, testing and commissioning of pre-fabricated package type Effluent treatment plant for plastic recycling unit waste.				
	Daily Avg. Sewage : 25 m ³ /day				
	PH : 6.0 - 8.0				
	BOD : 200 mg/l				
	S. Solids : 250 mg/l				
	COD : 600- 700 mg/l				
	Oil & grease : < 50 mg/l				
	Coliform : 10 ⁶ - 10 ⁷ counts / 100 ml				
	Effluent discharge standard after treatment:				
	Conforming to requirement approved standards				
	PH : 6.5 - 8.0				
	BOD 5 : < 10 mg/l				
	S. Solids : < 10 mg/l				
	COD : < 50 mg/l				
	Coliform : < 1000 counts / 100 ml				
	Effluent treatment plant shall include supply erection, testing & commissioning of the following items:				
1.1	Effluent pumps: Centrifugal type, non clog self priming pumps complete with valves, suction and delivery header of an approved make of suitable capacity capable of handling 8-10 mm size solids for untreated effluent mounted on a base plate, suitable vibration eliminated pads of approved design for pump foundation, motor to be suitable for 400/440 volts, 3 phase, 50 cycles AC supply with rpm, to suit the corresponding pumps.				
a)	Capacity suitable for 1.2 m³/hr at 10m head (For effluent lifting)	2	Nos		

1.2	Pre-Fabricated Package type Effluent treatment plant for washed plastic recycling unit waste of capacity 25 KLD in MS, internally FRP 4 lined inside and externally epoxy painted with 2 coats comprising of the following:				
a)	Air Blowers suitable for ETP 25 cum/day - 2 nos. (1w+1s) capacity 60m3/hr and 4000mmwc.	2	Nos		
b)	Air Grid with Diffusers as needed silicone make. - 1 Lot.	1	set		
c)	Flocculator 02 Nos cum Primary Tube Settler suitable for 25 KLD ETP in MS internally and externally FRP 4 lined complete with slow speed agitation process in the reaction tanks, de-sludge valve as required. Tube settler to be designed at a rise rate of 2.5m/hr. T Volume must not be less than: TS Volume: 2200 Litres; FFT Volume: 2000 Litres	1	set		
f)	Chemical dosing system for poly electrolyte, through electronic metering pumps. 0-10 LPH Q Dose/Equi. Dosing Tank Sintex/Equi. 100 Litres	1	set		
g)	Chemical dosing system for coagulant, through electronic metering pumps. 0-50 LPH Q Dose/Equivalent; Plunger type. Dosing Tank Sintex/Equivalent 100 Litres	1	set		
h)	Chemical dosing system for coagulant. Dosing tank to have slow speed agitation inside. Dosing Tank Sintex /Equivalent 100 Litres	1	set		
i)	Filter feed tank in MS internally FRP lined and externally painted with 2 coats of epoxy outside.	1	No		
j)	Foot Ladders proper form and shape and Platforms MS make of higher quality covering the entire complete treatment tank of the proposed ETP (<i>Not simple ladder but step based proper stairs needed</i>) with barrier at the platform where dosing tanks will be kept;	1	set		
h)	Tube Settler Media adequate sized with interlocking system	1	lot		

1.3	Tertiary treatment comprising of the following:				
a)	Filter Feed pumps: Centrifugal type, non clog self-priming pumps complete with valves, suction and delivery header of an approved make of suitable capacity for treated effluent mounted on a base plate, suitable vibration eliminated pads of approved design for pump foundation, motor to be suitable for 400/440 volts, 3 phase, 50 cycles AC supply with rpm, to suit the corresponding pumps. 2 nos. (1w+1s).	2	Nos		
	Capacity for 1.2 m ³ /hr at 30m head.				
c)	Vertical FRP Dual Media Filter: complete with initial charge of filter media, face piping and valves accessories, painting, testing and commissioning complete. The filter to be designed for a filtration velocity of 15m/hr. Pentair Make	1	set		
d)	Vertical FRP Activated carbon Filter: complete with initial charge of filter media, face piping and valves accessories, painting, testing and commissioning complete. The filter to be designed for a filtration velocity of 15m/hr. Pentair Make	1	set		
1.4	Sludge removal pumps: Centrifugal type, non clog self-priming pumps complete with valves, suction and delivery header of an approved make of suitable capacity for removal of the sludge from the tube settler mounted on a base plate, motor to be suitable for 400/440 volts, 3 phase, 50 cycles AC supply with rpm.	1	No		
1.5	Electrical panel: complete with all suitable feeders, contactors, etc. with MCCB, cable tray, feeder with all safety and enclosures. Switchgears to be of Schneider/Siemens	1	set		
1.6	Pipe lines and valves: MS C Class only / UPVC Astral make/ complete with fittings e.g. tees, crosses, plugs, sockets, elbows, reducers, supports and clamps, etc., cutting chases including painting of MS pipes and fittings.	1	Lot		

1.7	INSTRUMENTATION comprising of the following items.	1	Lot		
a)	Digital energy meter in the electrical panel - 1 No				
b)	Inlet Effluent water electromagnetic flow meter - 1 No				
c)	Outlet Water Flow Meter Inferential Dial Kranti /Best Model Available 1 No				
d)	Level switches for auto operation of system pump controls- I lot as required				
e)	Pressure Gauges as required Stainless steel				
1.8	UV system suitable for flow. Phillips UV and Stainless Steel body with all accessories	1	No		
1.9	Ultra-filtration System for the flow of 1.2m ³ /Hr with all accessories including CIP tank, CIP pump, Backwash pump, dosing pump, complete fitted with skid	1	set		
2	Installation, Training and commissioning Works at site for ETP	1	Job		
2.1	Transport, Transit Insurance and Unloading Expenses as per actual	1	Job		
	SUB TOTAL EFFLUENT TREATMENT PLANT				

NOTE:

Acceptable variations in dimensions of the machinery: +/- 5%

User / Technical manuals to be supplied in English.

THE OFFERED PRODUCTS ARE IN ACCORDANCE WITH THE REQUIRED SPECIFICATIONS AND TECHNICAL REQUIREMENTS:

YES

NO

ANY DEVIATIONS MUST BE LISTED BELOW:

Signature

Name _____

Designation with stamp

Date

Delivery Requirements	
Delivery date and time	Bidder shall complete the delivery and installation within 50 Days from the issuance of Contract.
Customs clearance	Shall be done by: <input checked="" type="checkbox"/> Supplier/bidder
Exact Address(es) of Delivery Location(s)	Detailed addresses will be provided at the time of award of contract.
Distribution of shipping documents (if using freight forwarder)	Not Applicable
Packing Requirements	Applicable
Training on Operations and Maintenance	Applicable
Warranty Period	12 months for ETP and 03 years for Civil Work
After-sales service and local service support requirements	Applicable
Preferred Mode of Transport	Not Applicable

Delivery Locations:

The shipment will be delivered to following locations. Detailed addresses will be provided at the time of award of contract.

City	LOT 1 Civil Work of Underground Tanks with Loading capacity of 5 Ton Platform	LOT 2 Effluent Treatment Plant
Material Recycling Centre, Bandurakh, Kunjawani, Jammu	1	1
Total	1	1

NOTES:

1. The products/goods/parts of machineries must be recalled by the manufacturer/ bidder/ supplier at the manufacturers/ bidder/ suppliers cost if rejected by CEE/ purchaser or end user because of the problems with quality. The supplier/ bidder/ manufacturer will be obliged to replace the products/goods/parts of machineries in question at its own cost with a new one of acceptable quality.
2. Detailed delivery and installation addresses will be provided at the time of award of contract.
3. The supplier will be responsible for protection of materials, property and equipment before successful delivery and handover to CEE.

4. **Unit prices quoted must be inclusive of all costs necessary to supply these items, including delivery, one-year warranty, transport cost, insurance, materials, installation, training and commissioning etc.**
5. Supplier to submit the focal point contact details for warranty issues for the duration of warranty period.
6. The civil work to be carried out as per BOQ and warranty for civil work will be 03 years.

ANNEX 2: QUOTATION SUBMISSION FORM

Bidders are requested to complete this form, including the Company Profile and Bidder's Declaration, sign it and return it as part of their quotation along with Annex 3: Technical and Financial Offer. The Bidder shall fill in this form in accordance with the instructions indicated. No alterations to its format shall be permitted and no substitutions shall be accepted.

Name of Bidder:		
RFQ reference:	RFQ/003/CEE IND 2023	Date:

Company Profile

Item Description	Detail
Legal name of bidder or Lead entity for JVs	
Legal Address, City, Country	
Website	
Year of Registration	
Legal structure	

Bank Information	Bank Name: Bank Address: IBAN: SWIFT/BIC: Account Currency: Bank Account Number:			
Previous relevant experience				
Name of previous contracts	Client & Reference Contact Details including e-mail	Contract Value	Period of activity	Types of activities undertaken

Bidder's Declaration

Yes	No	
<input type="checkbox"/>	<input type="checkbox"/>	Requirements, Terms, and Conditions: I/We have read and fully understand the RFQ, including the RFQ Information and Data, Schedule of Requirements, the General Conditions of Contract, and any Special Conditions of Contract. I/we confirm that the Bidder agrees to be bound by them.
<input type="checkbox"/>	<input type="checkbox"/>	I/We confirm that the Bidder has the necessary capacity, capability, and necessary licenses to fully meet or exceed the Requirements and will be available to deliver throughout the relevant Contract period.
<input type="checkbox"/>	<input type="checkbox"/>	Ethics: In submitting this Quote I/we warrant that the bidder: has not entered into any improper, illegal, collusive or anti-competitive arrangements with any Competitor; has not directly or indirectly approached any representative of the Buyer (other than the Point of Contact) to lobby or solicit information in relation to the RFQ; has not attempted to influence, or provide any form of personal inducement, reward or benefit to any representative of the Buyer.
<input type="checkbox"/>	<input type="checkbox"/>	I/We confirm to undertake not to engage in proscribed practices, , or any other unethical practice, with the CEE or any other party, and to conduct business in a manner that averts any financial, operational, reputational or other undue risk to the CEE and acknowledge that it provides the minimum standards expected of suppliers to the CEE.
<input type="checkbox"/>	<input type="checkbox"/>	Conflict of interest: I/We warrant that the bidder has no actual, potential, or perceived Conflict of Interest in submitting this Quote or entering a Contract to deliver the Requirements. Where a Conflict of Interest arises during the RFQ process the bidder will report it immediately to the Procuring Organization's Point of Contact.
<input type="checkbox"/>	<input type="checkbox"/>	Prohibitions, Sanctions: I/We hereby declare that our firm, its affiliates or subsidiaries or employees, including any JV/Consortium members or subcontractors or suppliers for any part of the contract is not under procurement prohibition by the CEE, including but not limited to prohibitions derived from the Compendium of CEE Sanctions Lists and have not been suspended, debarred, sanctioned or otherwise identified as ineligible by CEE.
<input type="checkbox"/>	<input type="checkbox"/>	Bankruptcy: I/We have not declared bankruptcy, are not involved in bankruptcy or receivership Proceedings, and there is no judgment or pending legal action against them that could impair their operations in the foreseeable future.
<input type="checkbox"/>	<input type="checkbox"/>	Offer Validity Period: I/We confirm that this Quote, including the price, remains open for acceptance For the Offer Validity.
<input type="checkbox"/>	<input type="checkbox"/>	I/We understand and recognize that you are not bound to accept any Quotation you receive, and we Certify that the goods offered in our Quotation are new and unused.
<input type="checkbox"/>	<input type="checkbox"/>	By signing this declaration, the signatory below represents, warrants and agrees that he/she has been Authorized by the Organization/s to make this declaration on its/their behalf.

Signature: _____

NAME:

TITLE:

DATE:

ANNEX 3: TECHNICAL AND FINANCIAL OFFER

Technical Offer

Provide the following:

- a brief description of your qualification and capacity that is relevant to the Scope of Works;
- a brief method statement and implementation plan;

Financial Offer

LOT NO. (a)	BRIEF DESCRPTION OF GOODS (b)	QTY. (In Nos.) (c)	CURRENCY (d)	MAKE & MODEL (e)	UNIT PRICE	TOTAL PRICE
					FINAL DESTINATION	FINAL DESTINATION
					(all inclusive) (f)	(all inclusive)
						(g) = (c) x (f)
1	Civil Work of RCC Underground Tanks with Loading capacity of 5 Ton Platform	1 Job				
2	Effluent Treatment Plant	1 Unit				
	Any other cost if any					
	Duty/ Tax (Nature and amount of each tax / duty component should be clearly specified)					
	TOTAL COST					
PROVIDED THAT A PURCHASE ORDER IS ISSUED BY CEE WITHIN THE REQUIRED BID VALIDITY PERIOD , THE UNDERSIGNED HEREBY COMMITS, SUBJECT TO THE TERMS OF SUCH PURCHASE ORDER, TO FURNISH ANY OR ALL ITEMS AT THE PRICES OFFERED AND TO DELIVER SAME TO THE DESIGNATED POINT(S) WITHIN THE DELIVERY TIME STATED IN RFQ.						

- Bidders should give cost of ETP plant including packing, loading, unloading at MRC, transportation & transit insurance costs.

<i>Exact name and address of company</i> COMPANY NAME _____ ADDRESS _____ PHONE NO. _____ FAX NO. _____ EMAIL ADDRESS OF CONTACT PERSON _____ OTHER EMAIL ADDRESSES _____	AUTHORIZED SIGNATURE DATE NAME OF UTHORIZED SIGNATORY (TYPE OR PRINT)FUNCTIONAL TITLE OF SIGNATORY WEB SITE
------------------------------------------------------------------------------------------------------------------------------------------------------------------------------------------	------------------------------------------------------------------------------------------------------------------------------------------

NOTE: Quoted price must be inclusive of all costs necessary to supply these items, including delivery, loading, unloading, warranty, transport cost, insurance, materials, installation, training and commissioning etc.

Compliance with Requirements

	You Responses		
	Yes, we will comply	No, we cannot comply	If you cannot comply, pls. indicate counter - offer
Delivery Lead Time	<input type="checkbox"/>	<input type="checkbox"/>	
Validity of Quotation	<input type="checkbox"/>	<input type="checkbox"/>	
Payment terms	<input type="checkbox"/>	<input type="checkbox"/>	
Other requirements <i>[pls. specify]</i>	<input type="checkbox"/>	<input type="checkbox"/>	

I, the undersigned, certify that I am duly authorized to sign this quotation and bind the company below in event that the quotation is accepted.	
<i>Exact name and address of company</i> Company Name Address: Phone No.: Email Address:	Authorized Signature: Date: Name: Functional Title of Authorized Signatory: Email Address:

FORM A: "CONSIGNEE ACCEPTANCE CERTIFICATE"

**(To be given by consignee's authorized
representative)**

The following goods have been received.

1. Name of the item supplied (with Make & Model) :-
2. Purchase Order/Contract No :-
3. Name of the Supplier:-
4. LOT No :-
5. No. of Units supplied:-
6. Place of destination:-
7. Invoice No. & Date:-
8. Name and Address of the Consignee:-
9. Date of receipt by the Consignee:-

The undersigned hereby certifies that the aforesaid goods have been received in good condition and accepted.

Signature_____

Name_____

Designation with stamp__

_____ Date_____

Countersigned by:

Signature_____

Name_____

Date_____

NOTE This certificate is to be filled up and issued by authorized representative of the consignee and is to be duly stamped and countersigned by the supervisor.

FORM B: SATISFACTORY INSTALLATION, TRAINING & COMMISSIONING CERTIFICATE

This is to certify that the goods as detailed below have been satisfactorily installed and commissioned and training provided in respect of their operational use:

- a) Purchase Order/ Contact No: _____ date _____
- b) Description of the machinery (with make & model no.): _____
- c) Batch/Serial Number(s) of the goods: _____
- d) Quantity: _____
- e) Name of the consignee: _____

The supplier has fulfilled his contractual obligation with regard to the following services:

- a) Satisfactory Installation, Performance and commissioning/start-up of machinery.
- b) Furnishing of tools required for assembly and / or maintenance of the
..... (Enter name of machinery with make & model)
- c) Furnishing detailed operation and maintenance manual for each item of supply at each location.
- d) Training of the operators/users in operating the equipment to the satisfaction of the consignee.

Signature _____

Name _____

Designation with stamp _____

Date _____

Countersigned

by: Signature _____

Name _____

Date _____

NOTE This certificate is to be filled up and issued by representative of the consignee and is to be duly stamped and countersigned by the supervisor.